



4 DIGIT



COMBI-PRIVATE (No. 821)

COMBI-PUBLIC (No. 822)



- ★ THE BEST EXPORTER 2006
- ★ THAI OWNED BRAND 2006
- ★ THAI OWNED DESIGN 2006
- ★ THAI OWNED BRAND 2012



**INTERNATIONAL
ARCH OF EUROPE
QUALITY AWARD
2011**



Certificate No. TH03/3040



Certificate No. TH03/3039

LOCKING OPTIONS:

FRONT

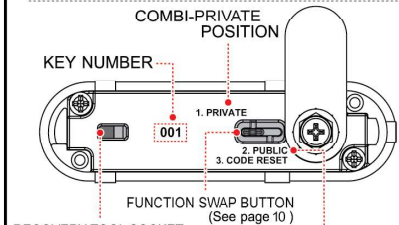
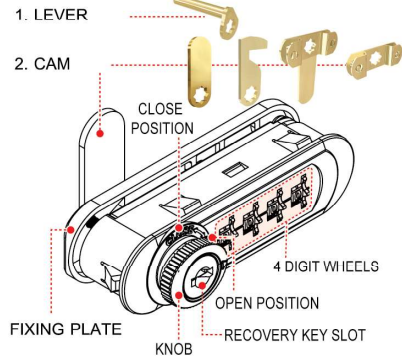

RECOVERY TOOL SOCKET

COMBI-PUBLIC POSITION
CODE RESET POSITION

BACK

2



K-085-91-CG

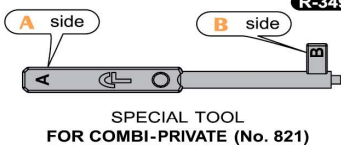

R-349-91

**SPECIAL TOOL
FOR COMBI-PRIVATE (No. 821)**

FOR GLASS DOOR CABINET

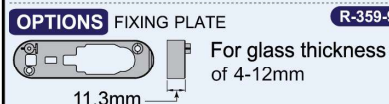
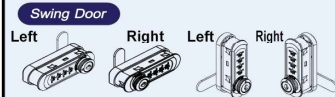

R-359-91

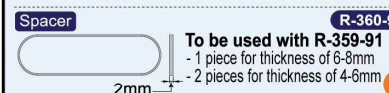

R-360-91

To be used with R-359-91
- 1 piece for thickness of 6-8mm
- 2 pieces for thickness of 4-6mm

3

DRILL HOLE

Finished

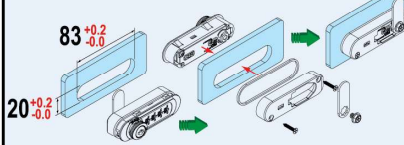

FOR METAL CABINET

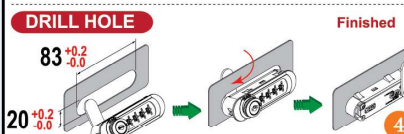
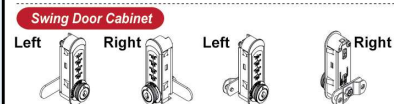
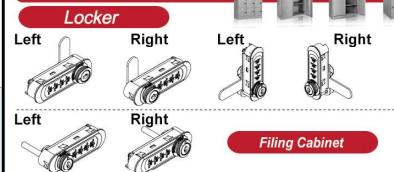

Finished

FOR WOODEN CABINET

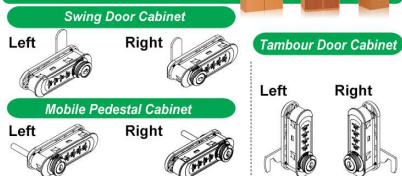

OPTIONS

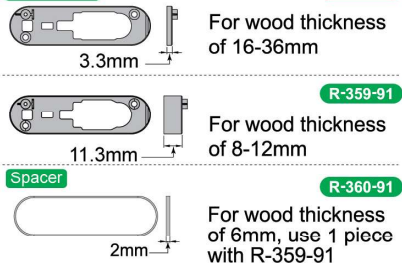

R-346-91

R-359-91

R-360-91

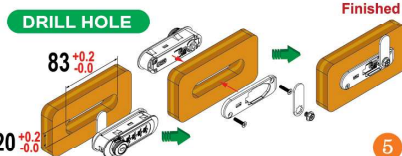

5

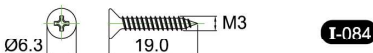
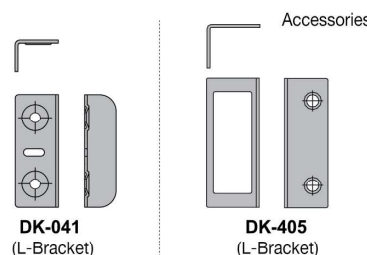

FOR WOOD THICKNESS OF 16 - 20mm

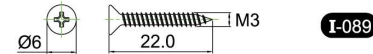

FOR WOOD THICKNESS OF 20 - 24mm



FOR WOOD THICKNESS OF 24 - 30mm



FOR WOOD THICKNESS OF 30 - 36mm

FOR WOODEN CABINET

6

**OPERATING INSTRUCTIONS
COMBI-PRIVATE (No. 821)**

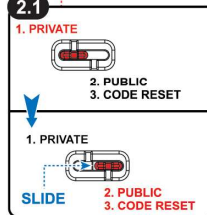
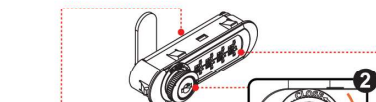
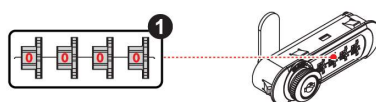

- The preset factory code is 0-0-0-0
- To change the secret code, rotate the knob to **OPEN** position.
 - Slide the function swap button to **3. CODE RESET**
 - The new secret code can be reset, e.g. 8-8-8-8

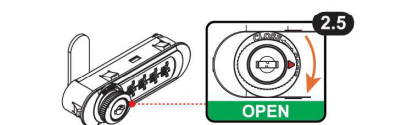
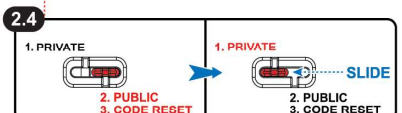
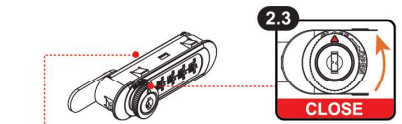

- Rotate the knob to **CLOSE** position.
- Slide the function swap button to **1. PRIVATE**
- Rotate the knob back to **OPEN** position to complete the process.

Remarks: For Step2, remove the cam should it obstruct the **FUNCTION SWAP BUTTON**.

8

3. In order to LOCK.
 3.1 Turn the dials to the set code, e.g. 8-8-8-8.
 3.2 Rotate the knob to **CLOSE** position.
 3.3 Turn the dials to any number for locking.

4. In order to UNLOCK.
 4.1 Turn the dials to the previously set secret code, e.g. 8-8-8-8.
 4.2 Rotate the knob to **OPEN** position.

9

TO RECOVER THE SECRET CODE COMBI - PRIVATE (No. 821)

1 WHEN THE LOCK IS IN OPEN POSITION

1. Insert the special tool provided with the lock into the **RECOVERY TOOL SOCKET** and hold it in position.

2. Turn each of the dials until it cannot move (all four dials)—to recover the forgotten secret code.

3. Pull the special tool out of the slot. The lock can now be used normally.

10

2 WHEN THE LOCK IS IN LOCK POSITION

1. Insert the key into the **RECOVERY KEY SLOT** and rotate it clockwise until stop.

2. Turn each of the dials until it cannot move (all four dials)—to recover the forgotten secret code.

3. Rotate the key counter-clockwise until stop and pull the key out. The lock can now be used normally.

11

OPERATING INSTRUCTIONS COMBI - PUBLIC (No. 822)

1. The preset factory code is 0-0-0-0.

2. To change the secret code,
 2.1 Rotate the knob to **OPEN** position.
 2.2 The new secret code can be reset, e.g. 8-8-8-8. The process is complete.

12

3. In order to LOCK.
 3.1 Rotate the knob to **CLOSE** position.
 3.2 Turn the dials to any number for locking.

4. In order to UNLOCK.
 4.1 Turn the dials to the previously set secret code, e.g. 8-8-8-8.
 4.2 Rotate the knob to **OPEN** position.

Remarks: The secret code for **COMBI-PUBLIC** can be reset when the lock is in **OPEN** position.

13

TO RECOVER THE SECRET CODE COMBI - PUBLIC (No. 822)

WHEN THE LOCK IS IN LOCK POSITION

1. Insert the key into the **RECOVERY KEY SLOT** and rotate it clockwise until stop.

2. Turn each of the dials until it cannot move (all four dials)—to recover the forgotten secret code.

3. Rotate the key in counter-clockwise until stop and pull the key out. The lock can now be used normally.

14

**FROM COMBI - PRIVATE (No. 821)
TO COMBI - PUBLIC (No. 822)**

1. The lock is in **OPEN** position.

2. Slide the **FUNCTION SWAP BUTTON** to **2.PUBLIC** to change the function to **COMBI-PUBLIC**.

Remarks: For Step2, remove the cam should it obstruct the **FUNCTION SWAP BUTTON**.

15

**FROM COMBI - PUBLIC (No. 822)
TO COMBI - PRIVATE (No. 821)**

1. The lock is in **OPEN** position.

2. The secret code can be reset right away, e.g. 8-8-8-8.

3. Rotate the knob to **CLOSE** position.

16

4. Slide the **FUNCTION SWAP BUTTON** to **1.PRIVATE**.

5. Rotate the knob to **OPEN** position to change the function to **COMBI-PRIVATE**.

Remarks: For Step4, remove the cam should it obstruct the **FUNCTION SWAP BUTTON**.

17